

**189 WHITEHALL WATERFRONT RIVERSIDE WAY**  
**LEEDS, LS1 4EG**

**£500,000**  
**LEASEHOLD**

Stunning City Centre Penthouse with Panoramic Leeds Skyline Views & Secure Underground Parking!  
Cash Buyers Only - Until Cladding Works Completed!

**M O N R O E**

SELLERS OF THE FINEST HOMES

# 189 WHITEHALL WATERFRONT

- Luxury Penthouse • Panoramic Skyline Views • No ESW1 - Cash Buyers Only! • Two Spacious Bedrooms • Floor to Ceiling Windows • Balconies From Both Aspects of Building • Secure Parking with Tandem Space • Close Proximity to Leeds Train Station



Step into a world of sophisticated city living with this exquisite Two bedroom, Two bathroom penthouse, perfectly positioned in the heart of Leeds City Centre. Offering a blend of contemporary style, breath taking views, and premium convenience, this exceptional home is designed for those who demand the very best.

## Unparalleled Views & Natural Light

With floor-to-ceiling windows, this stunning penthouse is flooded with natural light, creating an airy and inviting atmosphere throughout. Enjoy uninterrupted panoramic views of the vibrant Leeds skyline from multiple vantage points, bringing the city to life from the comfort of your own home.

## Spacious Open-Plan Living

Designed with modern lifestyles in mind, the open-plan living and dining area offers a perfect balance of style and functionality. Whether you're hosting guests or unwinding after a long day, this versatile space provides an elegant yet comfortable retreat.

## Sleek & Stylish Kitchen

The contemporary high-spec kitchen is a chef's dream, featuring premium integrated appliances, sleek cabinetry, and ample storage—ideal for cooking up a storm or enjoying relaxed dining at home.

## Two Generously Sized Bedrooms

Both bedrooms are thoughtfully designed, offering

plush carpets, fitted wardrobes, and direct access to a private balcony. The principal suite boasts an elegant ensuite bathroom, while the second bedroom is serviced by a chic family bathroom, making this home ideal for couples, professionals, or those looking for a stylish city pad.

## Two Private Balconies – Your Personal Outdoor Oasis

Step outside onto not one, but two private balconies, where you can sip your morning coffee, enjoy alfresco dining, or simply relax while taking in the breath taking cityscape.

## Tandem Parking Space in a Secure Car Park

A rare gem in the city centre, this penthouse comes with a highly sought-after tandem parking space within a secure, gated car park—offering complete peace of mind and ultimate convenience.

## Prime City Centre Location

Located in the heart of Leeds, this penthouse offers unrivalled access to top restaurants, trendy bars, shopping hotspots, and excellent transport links. Whether you're commuting, socialising, or indulging in everything the city has to offer, you'll never be far from the action.

This is city living at its finest! Don't miss out on this rare opportunity—book your viewing today!



## 189 WHITEHALL WATERFRONT

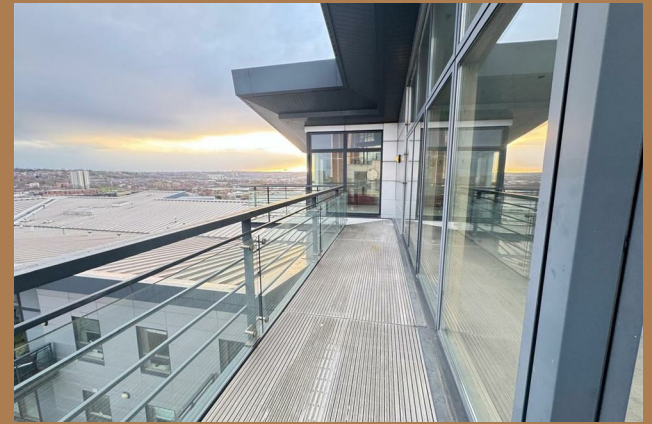

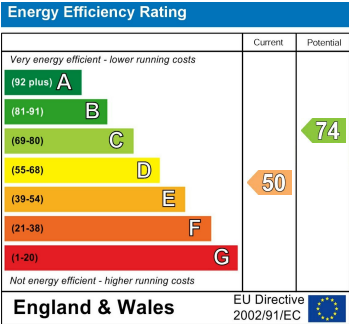
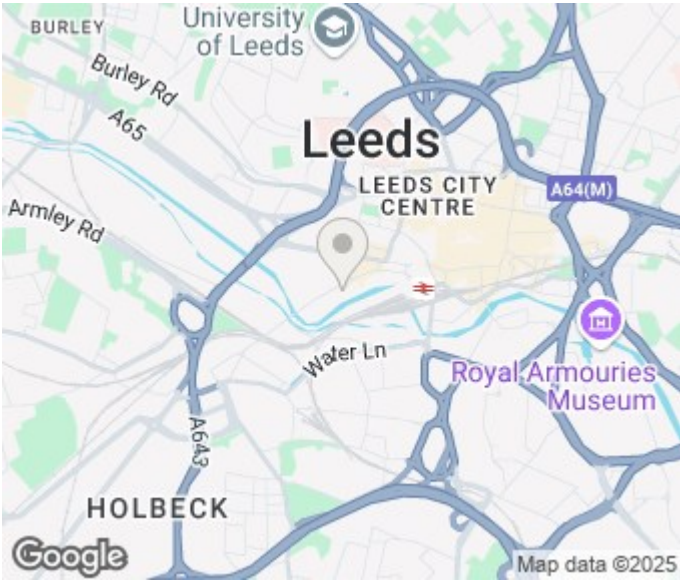

Agents Note: Whilst every care has been taken to prepare these particulars, they are for guidance purposes only. All measurements are approximate and are for general guidance purposes only and whilst every care has been taken to ensure their accuracy, they should not be relied upon and potential buyers/tenants are advised to recheck the measurements

Leeds City Centre  
Leeds City Centre  
Whitehall Road Leeds  
LS12 1FJ

0113 350 0866  
citycentre@monroeestateagents.com

MONROE

SELLERS OF THE FINEST HOMES